

San áireamh tá sonraíocht Shuirbhíreacht Orlandais Éireann arna éabhrú le fíor Cheadúnas OSI Uimh. 2010/15CCMA/Comhairle Contae na Gaillimhe. Séraíonn áisiú gearrú neamhdánaithe cáscheart Shuirbhíreacht Orlandais Éireann agus Rialtas na hÉireann.
 © Suirbhíreacht Orlandais Éireann, 2010.
 Includes Ordnance Survey Ireland data reproduced under OSI Licence number 2010/15CCMA/Galway County Council. Unauthorised reproduction infringes Ordnance Survey Ireland and Government of Ireland copyright.
 © Ordnance Survey Ireland, 2010.

Disclaimer Note:
 The constraints and options shown are draft only and subject to change. More detailed assessments, on-going studies and the information received from the public may result in changes to these constraints and options.

Nóta Séanta:
 Tá na srianta agus na roghanna atá léirithe ina bhfoirm dréacht, d'fhéadfaí athraithe teacht orthu. Is mar thoradh ar mheasúnaithe níos mionchruinne, ar staidéar leanúnach agus ar eolas ón bpobal go ndéanfar athruithe ar na srianta agus na roghanna seo.

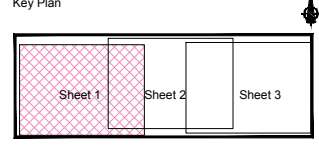

Job Title
N6 Galway City Transport Project

Scale
 N.T.S.

Date:
 August 2015

Issue	Date	By	Chkd	Appd
I1	28/08/2015	KJ	MH	EMC

Drawing Title
1st Environmental Workshop Record

Sheet 1 of 3

Drawing Status
Route Selection

Job No
233985-00

Drawing No
Figure 5.3.1.1

Issue
I1

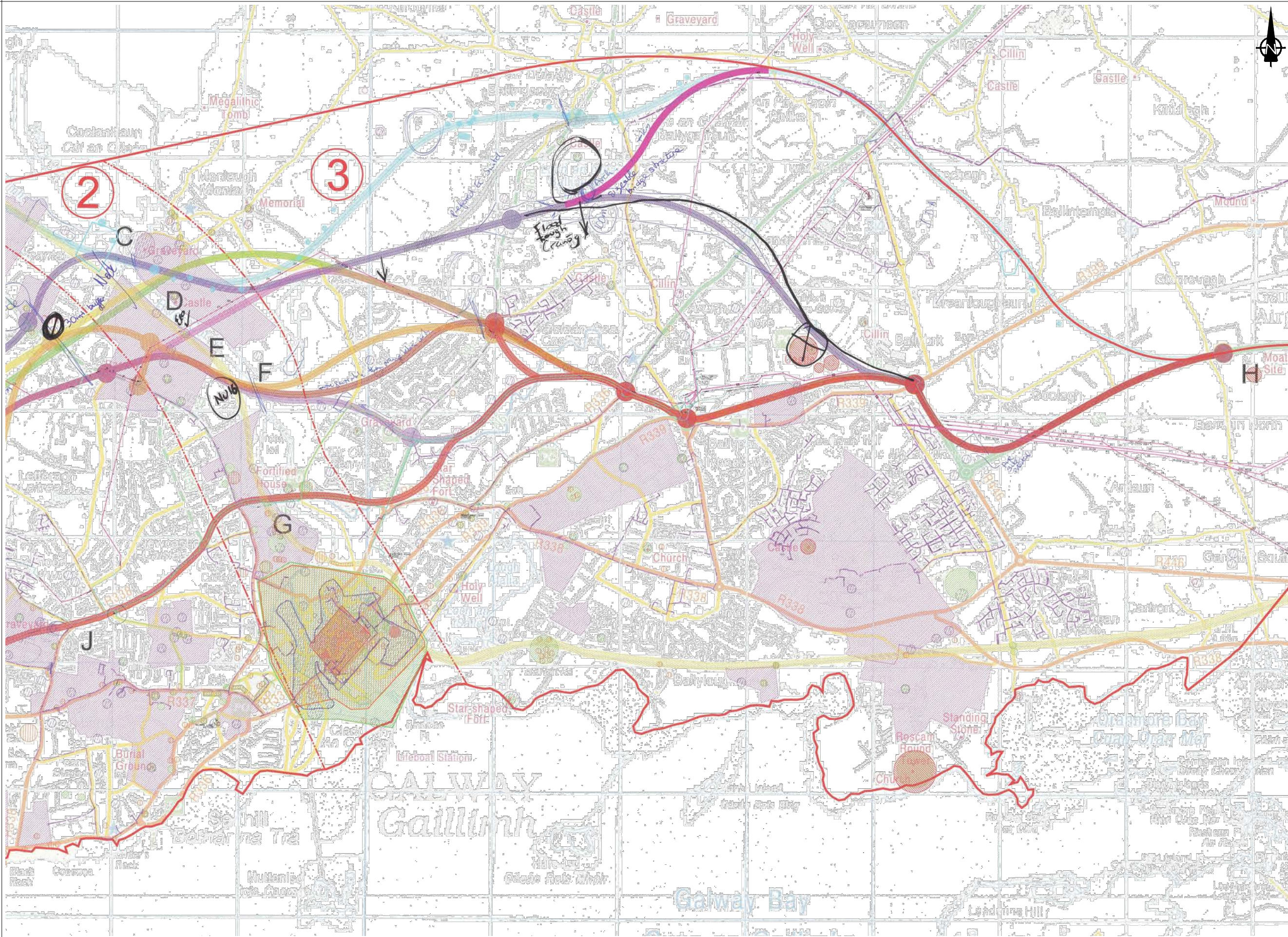

San áireamh tá sonraíocht Shuirbhíreacht Ordois Éireann arna éiríneadh faoi Cheadúnas OSI Uimh. 2010/15CCMA/Comhairle Contae na Gaillimhe. Séiríse arísigeadh neamhdánaithe clárcheart Shuirbhíreacht Ordois Éireann agus Riailtas na hÉireann. © Suirbhíreacht Ordois Éireann, 2010.

Includes Ordnance Survey Ireland data reproduced under OSI Licence number 2010/15CCMA/Galway County Council. Unauthorised reproduction infringes Ordnance Survey Ireland and Government of Ireland copyright. © Ordnance Survey Ireland, 2010.

Disclaimer Note:
The constraints and options shown are draft only and subject to change. More detailed assessments, on-going studies and the information received from the public may result in changes to these constraints and options.

Nóta Séanta:
Tá na srianta agus na roghanna atá léirithe ina bhíorma dréacht, d'fhéadfaí athraithe teacht orthu. Is mar thoradh ar mheasúnaithe níos mionchruinn, ar staidéir leanúnach agus ar eolas ón bpobal go ndéanfar athruithe ar na srianta agus na roghanna seo.

Clients

Galway City Transport Project

TIIV
Borradh Iompair Éireann

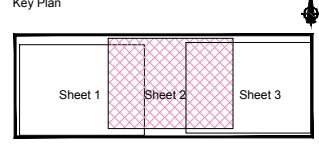

Consultant

ARUP

Corporate House
City East Business Park
Ballybri, Galway, Ireland.

Tel +353 (0)91 460675
www.N6GalwayCity.ie
www.arup.ie

Job Title
N6 Galway City Transport Project

Scale
N.T.S.

Date:
August 2015

Issue	Date	By	Chkd	Appd
I1	28/08/2015	KJ	MH	EMC

Drawing Title
1st Environmental Workshop Record

Sheet 2 of 3

Drawing Status
Route Selection

Job No
233985-00

Drawing No
Figure 5.3.1.2

Issue
I1

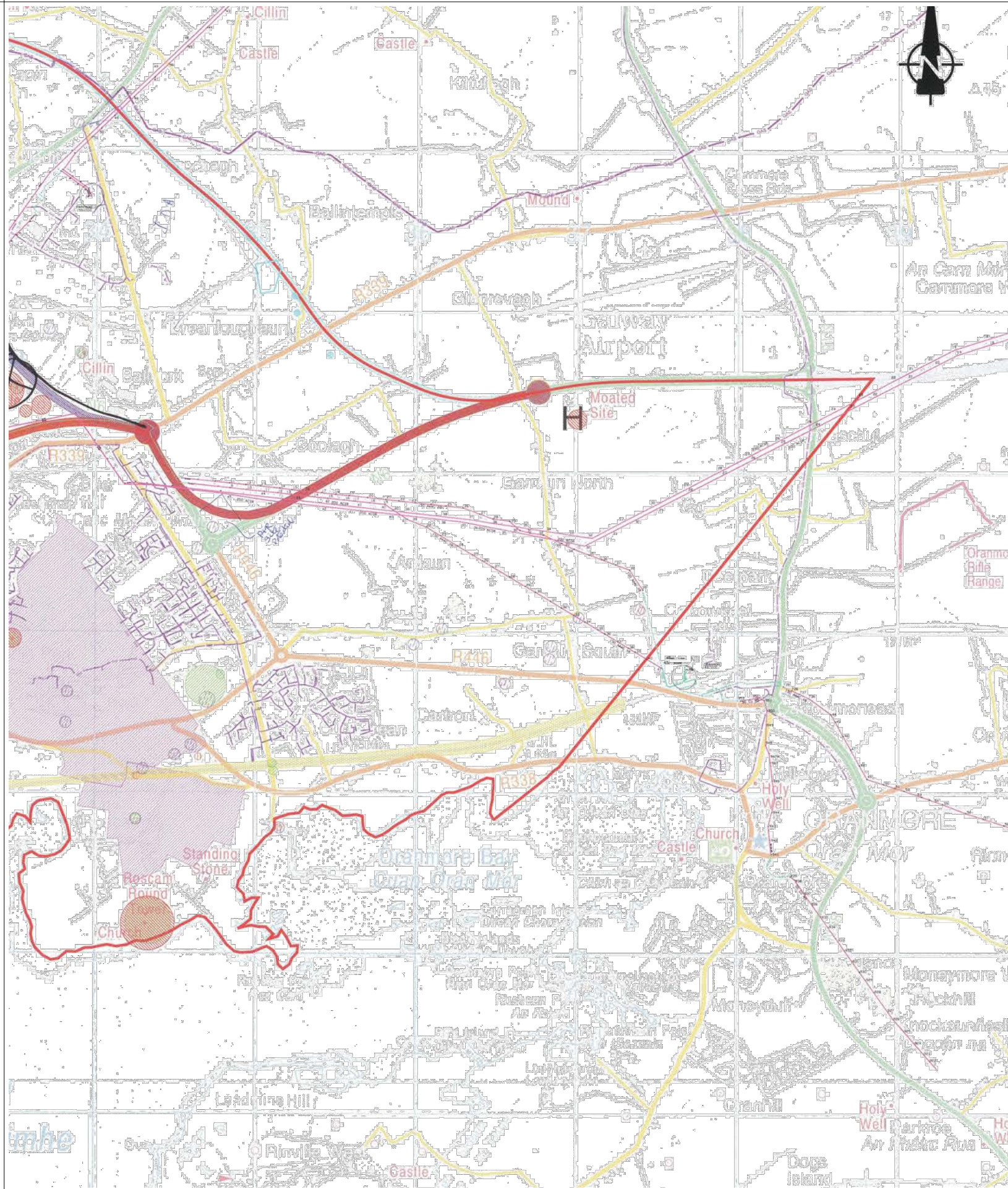

Legend Eochair Ordnance Survey Ireland *DISCOVERY SERIES* SRAITH EOLAIS

Eolas Tuairiscireachta General Information	Roinne Routes	Tairneanna Boundaries
Gairíne ginearálta General features	Seandhomhartha Antiquities	Relief
Gairíne uisce Water features	Tairneanna Boundaries	

ROUTE SELECTION

LEGEND:

Study Area	Study Area Sector Border	Study Area Sector Number
Potential Route Options	Existing Utilities Constraints:	Cultural Heritage Constraints:
Red Route Option	GAS transition pipe	Demesne / Designed landscapes
Blue Route Option	GAS distribution pipe	Cultural heritage site
Orange Route Option	ESB overhead 110kV	Sites/structures of archaeological or built heritage potential
Purple Route Option	ESB overhead 38kV	NIAH structures, which refer to buildings
Brown Route Option	ESB underground 38kV	Protected Structures
Pink Route Option		Architectural Conservation Areas
Green Route Option		Record of Monuments and Places
Yellow Route Option		National Monuments or Monuments with Preservation Orders
Cyan Route Option		
Switch 1		
Switch 2		

ARUP
N6 Galway City Outer Bypass

Route Selection - Engineering
GAS, ESB, Cultural Heritage
Constraints Sheet 1 of 1

San áireamh tá sonraíocht Shuirbhíreacht Orlandis Éireann arna eagrú agus foartha ag Ceannas OSÍ Uimh. 2010/15CCMA/Comhairle Contae na Gaillimhe. Sraibtear na sonraíocht seo i ndiaidh na cúlúcháir Shuirbhíreacht Orlandis Éireann agus Riailtas na hÉireann.

Includes Ordnance Survey Ireland data reproduced under OS Licence number 2010/15CCMA/Galway County Council. Unauthorised reproduction infringes Ordnance Survey Ireland and Government of Ireland copyright. © Ordnance Survey Ireland, 2010.

Disclaimer Note:
The constraints and options shown are draft only and subject to change. More detailed assessments, on-going studies and the information received from the public may result in changes to these constraints and options.

Nóta Séanta:
Tá na srianta agus na roghanna atá léirithe ina bhfoirm dréacht, d'fhéadfaí athraithe teacht orthu. Is mar thoradh ar mheasúnaithe níos mionchruinne, ar staidéir leanúnach agus ar eolas ón bpobal go ndéanfar athruithe ar na srianta agus na roghanna seo.

Clients

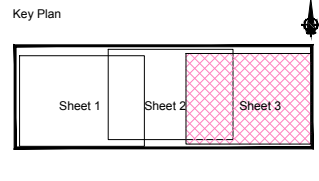

Consultant

ARUP

Corporate House
City East Business Park
Ballybri, Galway, Ireland.

Tel +353 (0)91 460675
www.N6GalwayCity.ie
www.arup.ie

Job Title
N6 Galway City Transport Project

Scale
N.T.S.

Date:
August 2015

Issue	Date	By	Chkd	Appd
I1	28/08/2015	KJ	MH	EMC

Drawing Title
1st Environmental Workshop Record

Sheet 3 of 3

Route Selection

Job No: **233985-00** | Drawing No: **Figure 5.3.1.3** | Issue: **I1**